

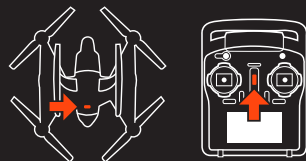

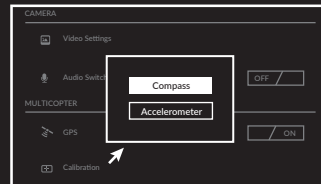

Step 1: Do not calibrate compass inside parking structures, near buildings and metal core roads. For best performance, only calibrate in open fields far away from power lines and other metallic or concrete structures.



Step 2: Power on the aircraft and the controller and make sure they are connected correctly (If they are not connected correctly, the telemetry data will not display on the screen).



Step 3: Tap the Setting button  on the ST10+ screen, then tap the Calibration button. Choose Compass option and tap it.

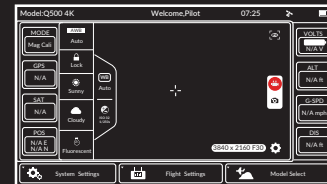

Step 4: If successful, THPHOON will beep. Return to the main screen. 'Mag Cali' will be displayed in MODE area.

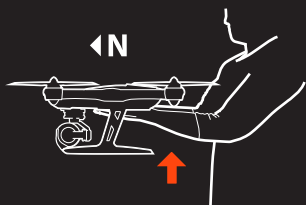

Step 5: Pick up the aircraft and hold it flat in your hands with its nose pointed to the north. After 5 seconds of flashing slowly, the main LED will start flashing rapidly.



Step 6: Slowly rotate the aircraft 360 degrees as illustrated, until it is flat and upright in your hands again.



Step 7: Rotate the aircraft 45 degrees to the left. Then slowly rotate the aircraft 360 degrees as illustrated, until it is flat and upright in your hands again.



Step 8: Rotate the aircraft 45 degrees to the left. Then slowly rotate the aircraft 360 degrees as illustrated, until it is flat and upright in your hands again.



Step 9: Rotate the aircraft 45 degrees to the left. Then slowly rotate the aircraft 360 degrees around as illustrated, until it is flat and upright in your hands again.



Note: Step 6 to 9 should be completed in a time period of 30 seconds in order to successfully complete the calibration.

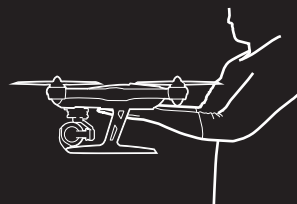

Step 10: The main LED on the aircraft should now be blinking rapidly. Hold the aircraft as still as possible until it stops blinking rapidly.



Step 11: If successful the aircraft will beep a positive confirmation and then restart itself. Your aircraft is now ready to fly! (Failed calibration results in white glowing main LED).

LED STATUS INDICATIONS DURING STARTUP

Main LED Status Indicator

- Initialization in progress
- Initialization failed
- The aircraft is in 'bind' mode
- The aircraft is not connected/linked to the transmitter
- The aircraft is in a no-fly zone*

*Please see the instruction manual for more information regarding no-fly zones

- Flashes red, green and blue (2 times per second)
- Pulses red (3 times per second)
- Flashes orange very rapidly (10 times per second)
- Flashes blue rapidly (5 times per second)
- Flashes red and white rapidly (5 times per second)

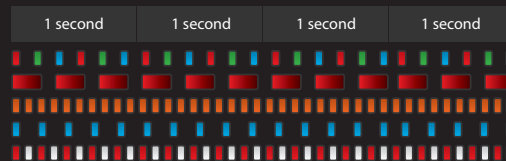

LED STATUS INDICATIONS BEFORE/DURING FLIGHT

Main LED Status Indicator

- The aircraft is in Smart Mode with GPS lock
- The aircraft is in Smart Mode without GPS lock
- The aircraft is in Angle Mode with GPS lock
- The aircraft is in Angle Mode without GPS lock
- The aircraft is in Home Mode
- Active Home Mode Activated
- Active Smart Mode, Follow Me / Watch Me Feature Activated
- First level low voltage battery warning
- Second level low voltage battery warning
- GPS lost

- Glow solid green
- Flashes green (3 times per second) then off (for 1 second)
- Glow solid purple
- Flashes purple (3 times per second) then off (for 1 second)
- Flashes red rapidly (5 times per second)
- Flashes red rapidly (5 times per second) for 3 seconds and white for 1 second
- Solid green for 3 seconds and white for 1 second
- Flashes red, green and blue every 3 seconds
- Flashes red, green and blue continuously
- Flashes purple (1 flash per second)



Below Motor Led Status Indicators

- Low voltage battery warning

- Flashes rapidly (5 times per second)

LED STATUS INDICATIONS FOR CALIBRATION MODES

Main LED Status Indicator

- Compass calibration Mode entered
- Compass calibration started
- Accelerometer calibration started
- Accelerometer calibration Mode entered/data collection finished
- Calibration failed

- Flashes red and green slowly (2 times per second)
- Flashes red and green rapidly (5 times per second)
- Flashes red, green and blue rapidly (3 times per second)
- Flashes red, green and blue slowly (1 time per second)
- Glow solid white

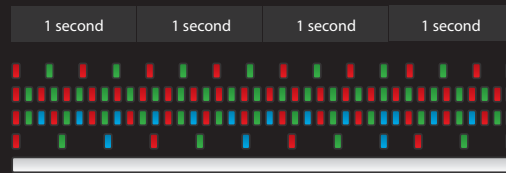

CGO3 CAMERA LED STATUS INDICATIONS

- Without T-card or T-card Memory Full
- WiFi Error
- WiFi Initialized
- WiFi Connected to Terminal
- Recoding Video or Taking Still Photos

- Flashes yellow
- Flashes red
- Flashes green
- Glow solid green
- Flashes green ,blue slowly

